

Farrelly Pool

San Leandro City Council

November 4, 2019



State of the City Pools

1. Farrelly Pool: Demolition complete, new pool planned for Quarter 1 2021.
2. Boys and Girls club Pool: Entire building is closed for renovation including pool resurfacing. Opening again in Quarter 1 2021.
3. Manor Pool: Existing pool is operating year round. Will close for construction of additional pool and parking in 2021.

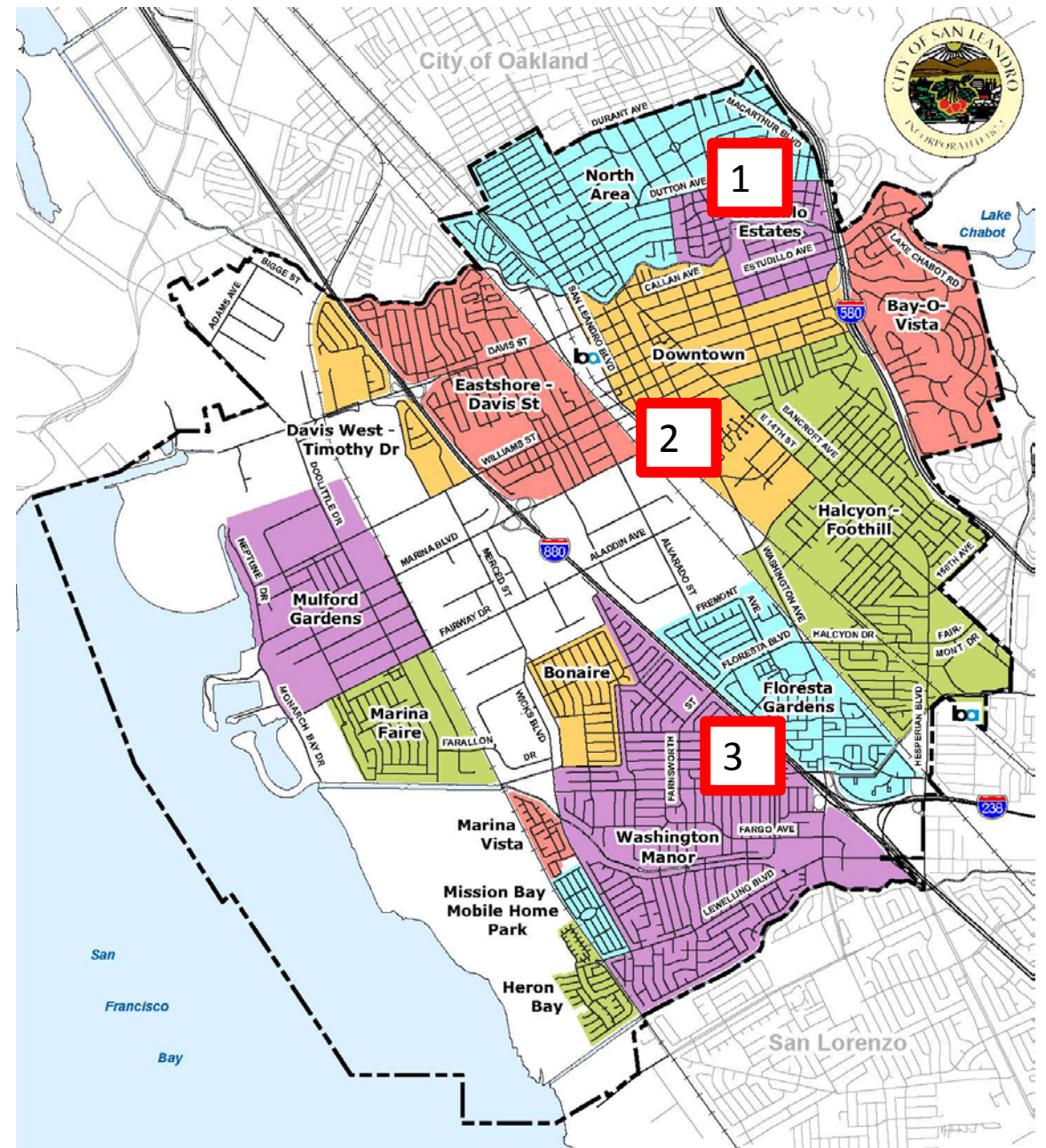

Farrelly Pool Timeline

1928 Pool and facilities built

2015 Last season of operation

7/2017 Funded replacement of the pool and pool equipment.

4/2018 Hired Glass Architects to design project

10/2018 Architect determines that new pool equipment won't fit within existing building. Expanding the building will trigger upgrades to the entire building.

1/2019 Discussed options with Facilities and Transportation Committee. Determined that a new facility was best option.

6/2019 1st bid: \$6.6M

10/2019 2nd bid: \$6.2M

Farrelly Pool Features

- All New Facility:
- Entrance
- Exiting
- ADA and staff parking
- Expanded Site

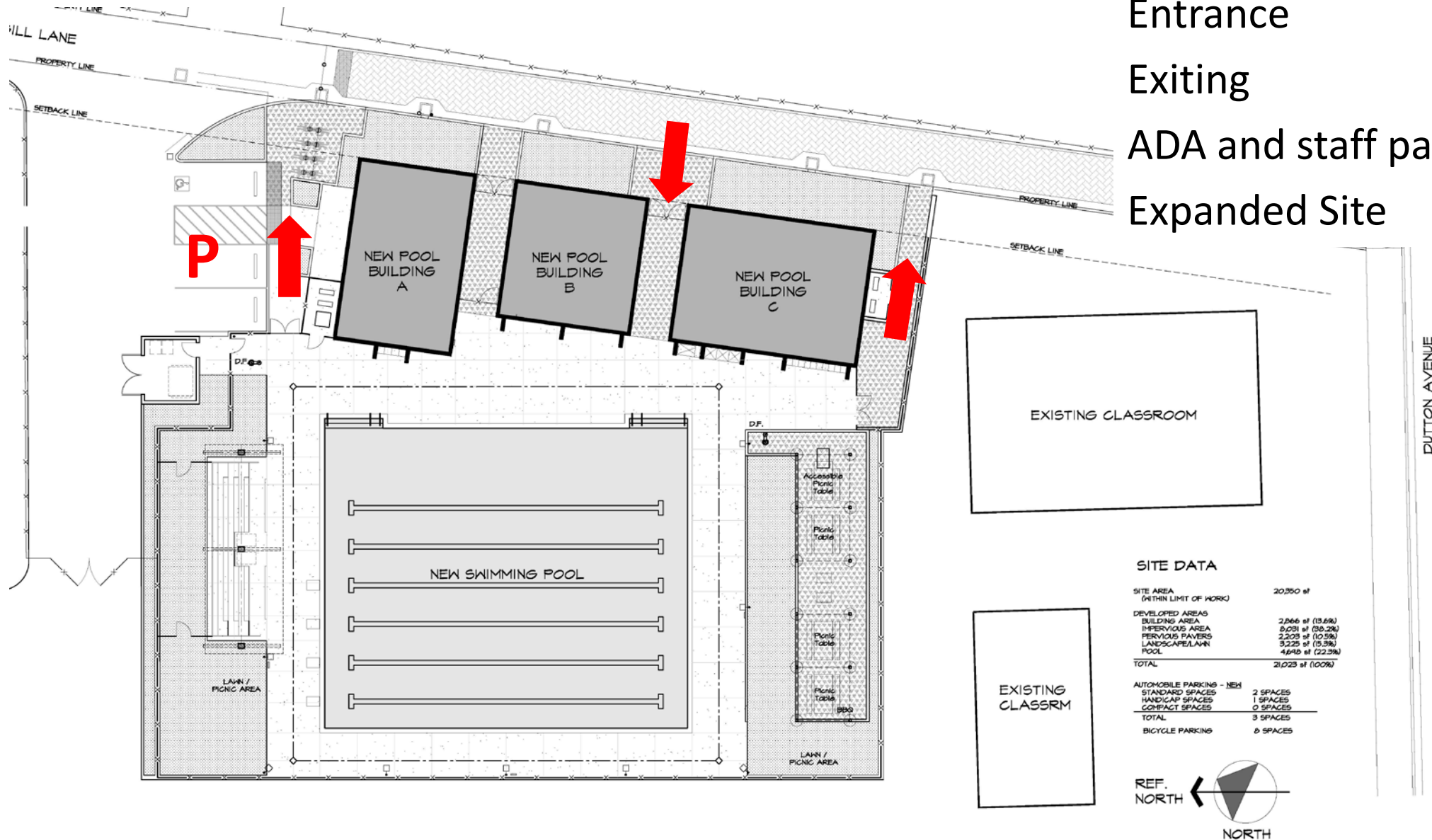

Farrelly Pool Features



Note: Fencing will be solid and taller.

LEED Silver
Building
Pool

Shade Structures
Site Furniture
Landscaping
Fencing

Farrelly Pool Features

- Transaction Window
- Staff area
- First Aid area
- Plumbing Fixtures
- Single occupancy restrooms
- Exterior showers
- Pool Equipment
- Chemical Storage

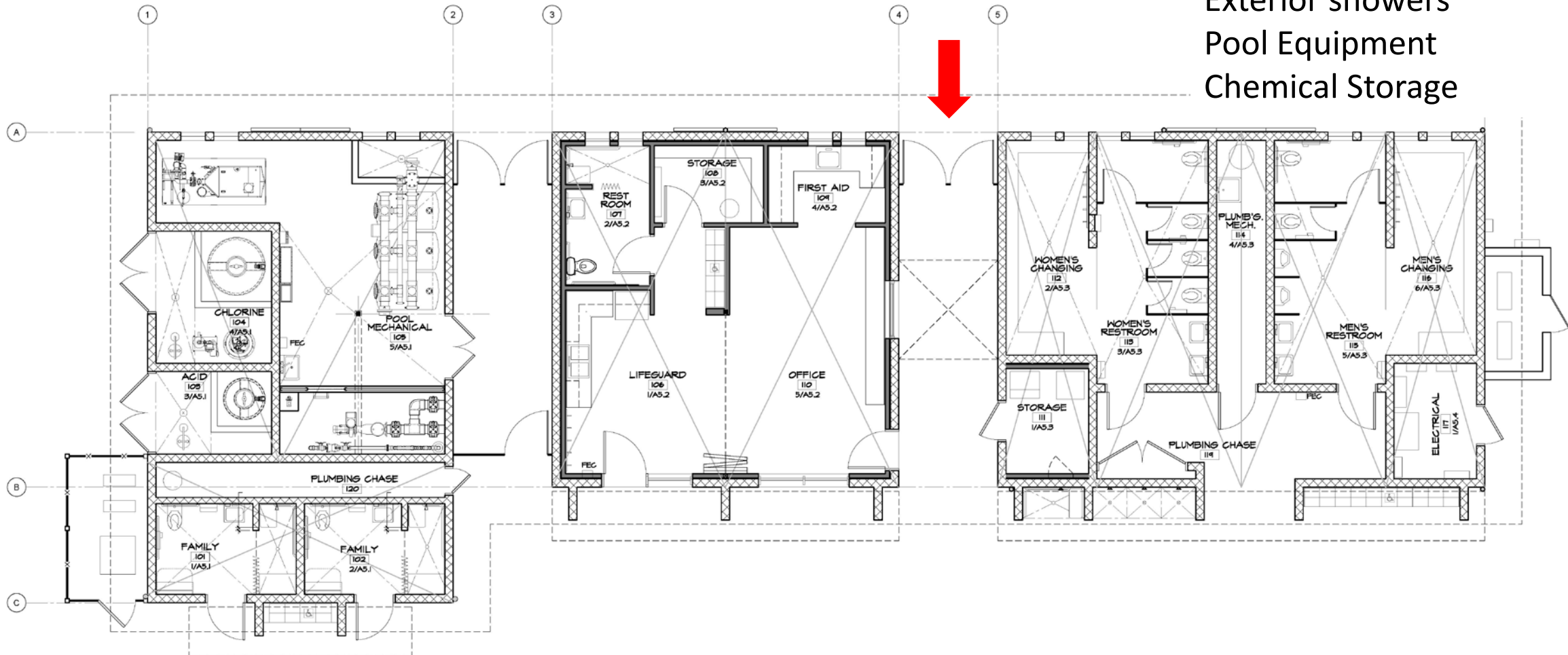

1 FLOOR PLAN
1/4" = 1'-0"

Farrelly Pool Financials

Description	\$ M	Funding	\$ M
Design	0.4	Original funding for pool and equipment	3.5
LEED Design	0.2	Added funding FY 19/20	1.1
Demolition	0.2		Subtotal 4.6
Utilities, Permits, Special Construction	0.3	Funding requested	3.9
Buildings	2.7		Total 8.5
Pool	1.6		
Site	1.9		
Construction Management and Inspection	0.3		
Contingency	0.9		
Total	8.5		



Next Steps

- **Discussion**
 - **Construct Farrelly Pool**
 - **Construct Boys and Girls Club Pool**
 - **Complete Design of Competition Pool for Washington Manor Family Aquatic Center at Manor Park**
- 