

THESE DRAWINGS ARE BEING RELEASED TO THE PLAN REVIEWER, CULLEN-SHERRY & ASSOCIATES, INC. FOR REVIEW ONLY. ANY CHANGES TO THESE DRAWINGS MUST BE MADE BY THE DESIGNER. THE DESIGNER IS NOT RESPONSIBLE FOR ANY ERRORS OR OMISSIONS IN THESE DRAWINGS. THE USER OF THESE DRAWINGS SHALL BE RESPONSIBLE FOR OBTAINING ALL NECESSARY PERMITS AND APPROVALS FROM THE APPROPRIATE AGENCIES. THE USER SHALL BE RESPONSIBLE FOR OBTAINING ALL NECESSARY PERMITS AND APPROVALS FROM THE APPROPRIATE AGENCIES. THE USER SHALL BE RESPONSIBLE FOR OBTAINING ALL NECESSARY PERMITS AND APPROVALS FROM THE APPROPRIATE AGENCIES.

COMMON AREA
SUBD 4456

AURORA GREENS CONDOMINIUMS
13517
AURORA DR.
(NOT SURVEYED)

EXIST. HOUSE



LEGEND

- NEW PRIVATE ASPHALT DRIVE
- CONCRETE DRIVEWAY w/ 1/4" SCORE MARKS @ 4" ON CENTER, EACH WAY, 6" CONCRETE, OVER 4" CL 2 AB, WITH 6"x6" WIRE MESH
- PERMEABLE PAVERS, STORM TREATMENT AREA w/ SUBDRAINS, STORM INLET, PIPE OUT SEE DETAILS, SHEET 3
- CONCRETE WALK TO UNIT, w/ SCORE MARKS, 4" CONC, OVER 4" CL 2 AB
- DRAINAGE HI POINT
- DIRECTION OF DRAINAGE
- NEW STORM LINE
- NEW SEWER LINE w/ SEWER LATERAL, CLEANOUT TO UNIT
- NEW WATER LINE w/ SERVICE LATERAL AND METER BANK

NOTES:

1. ELEVATIONS BASED UPON CITY OF SAN LEANDRO BENCH MARK, NAIL IN TOP OF CURB AT CATCH BASIN, SOUTHEAST CORNER OF AURORA DR. & W. AVE 136th, CONVERTED TO NAVD 1988. THIS PROPERTY IS OUTSIDE 1% CHANCE FLOOD PLAIN.
2. BOUNDARY HEREON IS BASED UPON MONUMENT LINE IN AURORA DR. PER MAP 120, PG. 87, ALAMEDA COUNTY RECORDS. THIS PROPERTY CONSISTS OF 3 EXISTING PARCELS. UPON APPROVAL OF THIS PROJECT, ALL PARCELS WILL BE MERGED INTO 1.
3. GRADES AND UTILITIES SHOWN HEREON ARE PRELIMINARY. SUBJECT TO CHANGE AS FINAL WORKING DRAWING ARE PREPARED.

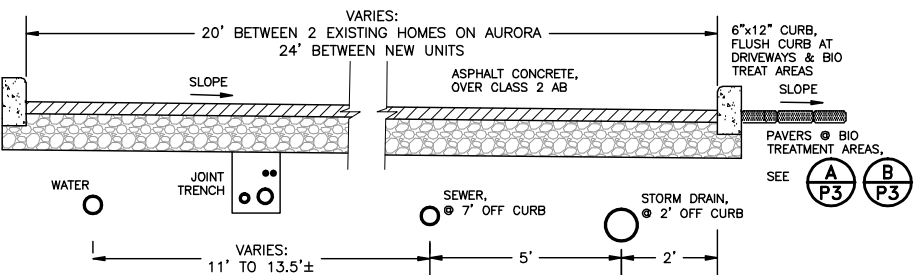
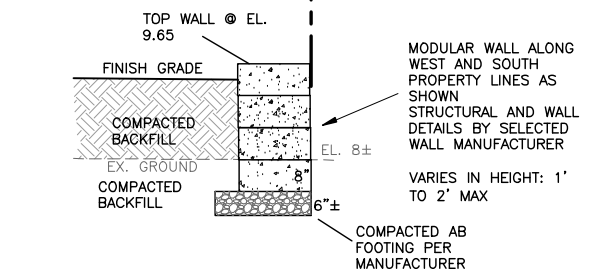
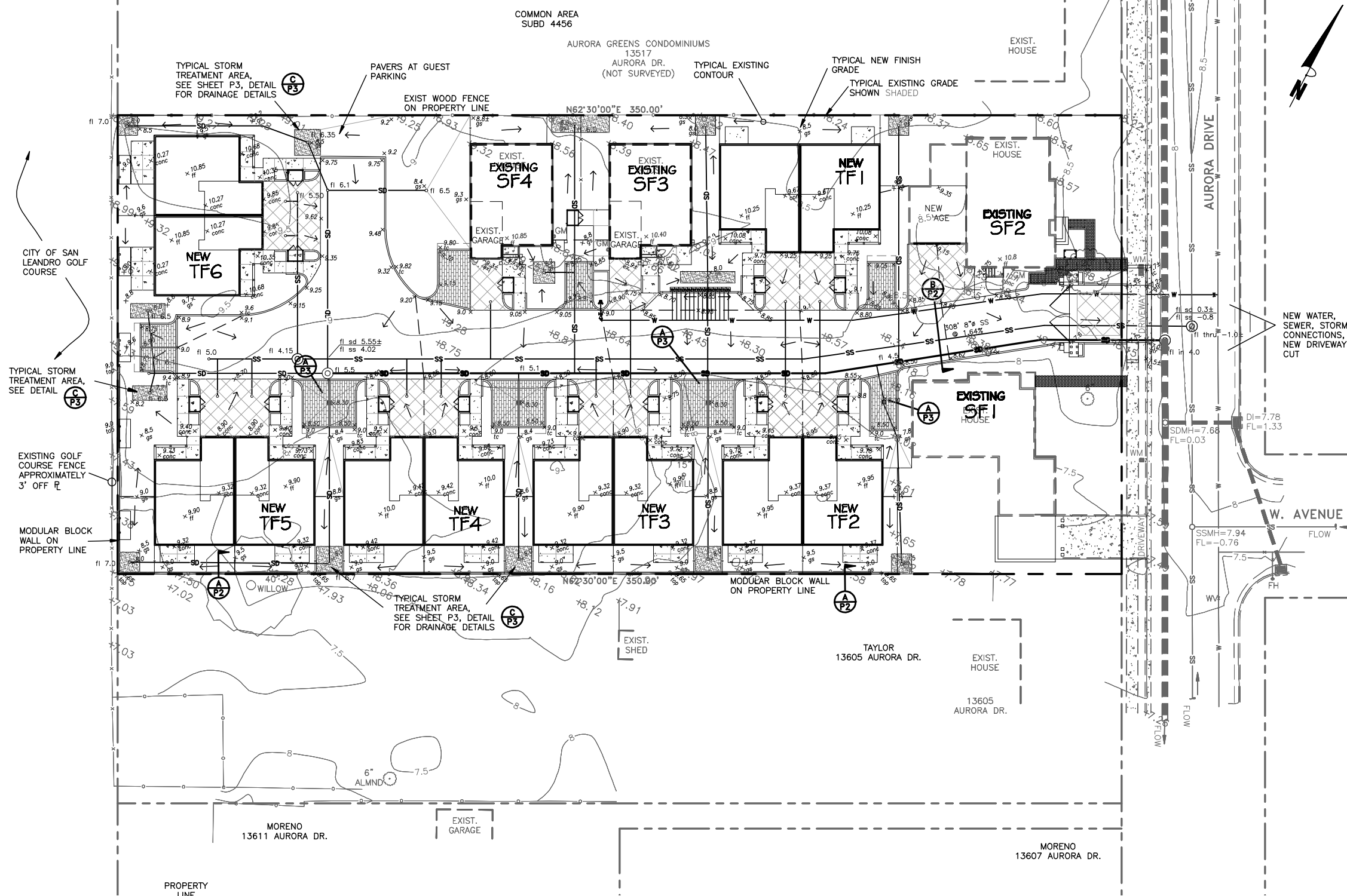

A MODULAR BLOCK WALL DETAIL
NTS

B PRIVATE STREET SECTION
NTS

REV	DATE	DESCRIPTION	BY

Cullen-Sherry & Associates, Inc.
 Civil Engineering - Surveying
 1080 Adams Street, Suite A - P.O. Box 591, Benicia, California 94610
 (707) 745-8219 Fax (707) 745-9436 csa-engineers.com
 Dan Cullen RCE 26162 Rod Sherry RCE 61537

AURORA COTTAGE
PRELIMINARY GRADING, DRAINAGE, AND UTILITY PLAN
 SAN LEANDRO, CALIFORNIA
 PREPARED FOR: FOOD SPECIALISTS, INC.

SCALE: 1"=20'
 DATE: 11-13-12
 DESIGN BY: DC
 DRAWN BY: DC
 CHECKED BY: DC
 FIELD BOOK:
 SHEET NUMBER:

P2
 OF 3 SHEETS
 PROJECT # 12228

11-13-12
 PRELIMINARY,
 INCOMPLETE,
 PROGRESS PRINT