

**OWNER'S STATEMENT**

WE HEREBY STATE WE ARE THE OWNERS OF OR HAVE SOME RIGHT, TITLE OR INTEREST IN AND TO THE REAL PROPERTY INCLUDED WITHIN THE SUBDIVISION SHOWN ON THIS MAP; THAT WE ARE THE ONLY PERSONS WHOSE CONSENT IS NECESSARY TO PASS A CLEAR TITLE TO SAID REAL PROPERTY: THAT WE HEREBY CONSENT TO THE MAKING AND RECORDING OF SAID MAP AND THE SUBDIVISION AS SHOWN WITHIN THE DISTINCTIVE BORDER LINE; AND DO HEREBY OFFER FOR DEDICATION AND DO HEREBY DEDICATE TO THE CITY OF SAN LEANDRO FOR THE BENEFIT OF PUBLIC RIGHT OF WAY THE AREA ALONG JUANA AVENUE AS SHOWN HEREON. THE MAP SHOWS ALL EASEMENTS ON THE PREMISES, OR OF RECORD.

INNISFREE VENTURES, II LLC, A LIMITED LIABILITY COMPANY  
BY: DAVID C. IRMER

BY: \_\_\_\_\_ BY: David C. Irmer  
NAME & TITLE: \_\_\_\_\_ NAME & TITLE: DAVID C. IRMER  
MANAGER

DATED THIS 12 DAY OF June, 2014.

**OWNER'S ACKNOWLEDGMENT**

STATE OF CALIFORNIA )  
COUNTY OF San Mateo ) SS

ON 6/12/14, 2014, BEFORE ME Alex Izard A NOTARY PUBLIC IN AND FOR SAID COUNTY, PERSONALLY APPEARED David C. Irmer AND WHO PROVED TO ME ON THE BASIS OF SATISFACTORY EVIDENCE TO BE THE PERSON(S) WHOSE NAME IS SUBSCRIBED TO THE WITHIN INSTRUMENT AND ACKNOWLEDGED TO ME THAT THEY EXECUTED THE SAME IN THEIR AUTHORIZED CAPACITY, AND THAT BY THEIR SIGNATURE ON THE INSTRUMENT THE PERSON(S) OR ENTITY UPON BEHALF OF WHICH THE PERSON(S) ACTED, EXECUTED THE INSTRUMENT.  
I CERTIFY UNDER PENALTY OF PERJURY UNDER THE LAWS OF THE STATE OF CALIFORNIA THAT THE FORGOING PARAGRAPH IS TRUE AND CORRECT.  
WITNESS MY HAND

SIGNATURE: [Signature] June 18, 2015  
NOTARY'S SIGNATURE EXPIRATION OF NOTARY'S COMMISSION  
Alex Izard  
PRINT NOTARY'S NAME COUNTY  
San Mateo  
COMMISSION # 1937650  
PRINCIPAL PLACE OF BUSINESS

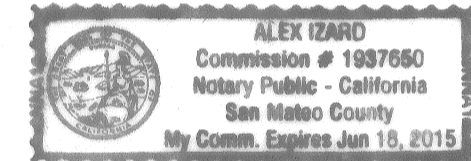

**OWNER'S ACKNOWLEDGMENT**

STATE OF CALIFORNIA )  
COUNTY OF \_\_\_\_\_ ) SS

ON \_\_\_\_\_, 2014, BEFORE ME \_\_\_\_\_ A NOTARY PUBLIC IN AND FOR SAID COUNTY, PERSONALLY APPEARED \_\_\_\_\_ AND WHO PROVED TO ME ON THE BASIS OF SATISFACTORY EVIDENCE TO BE THE PERSON(S) WHOSE NAME IS SUBSCRIBED TO THE WITHIN INSTRUMENT AND ACKNOWLEDGED TO ME THAT THEY EXECUTED THE SAME IN THEIR AUTHORIZED CAPACITY, AND THAT BY THEIR SIGNATURE ON THE INSTRUMENT THE PERSON(S) OR ENTITY UPON BEHALF OF WHICH THE PERSON(S) ACTED, EXECUTED THE INSTRUMENT.  
I CERTIFY UNDER PENALTY OF PERJURY UNDER THE LAWS OF THE STATE OF CALIFORNIA THAT THE FORGOING PARAGRAPH IS TRUE AND CORRECT.  
WITNESS MY HAND

SIGNATURE: \_\_\_\_\_ EXPIRATION OF NOTARY'S COMMISSION  
NOTARY'S SIGNATURE  
PRINT NOTARY'S NAME COUNTY  
PRINCIPAL PLACE OF BUSINESS  
COMMISSION #

**RECORDER'S STATEMENT**

FILED THIS \_\_\_\_\_ DAY OF \_\_\_\_\_, 2014, AT \_\_\_\_\_ M. IN BOOK \_\_\_\_\_ OF PARCEL MAPS, AT PAGE \_\_\_\_\_, AT THE REQUEST OF \_\_\_\_\_ FIRST AMERICAN TITLE COMPANY.  
FEE: \$ \_\_\_\_\_ SERIES NO: \_\_\_\_\_

BY: \_\_\_\_\_ PATRICK O'CONNELL  
DEPUTY COUNTY SURVEYOR COUNTY RECORDER IN AND FOR  
THE COUNTY OF ALAMEDA, STATE OF CALIFORNIA

**PARCEL MAP 10227**

A PORTION OF BLOCK 14 OF THE MAP OF ESTUDILLO TRACT  
FILED FOR RECORD IN MAP BOOK 5, PAGE 32, OFFICIAL RECORDS  
CITY OF SAN LEANDRO, COUNTY OF ALAMEDA, STATE OF CALIFORNIA  
SLOOTEN CONSULTING, INC.  
JANUARY 2014

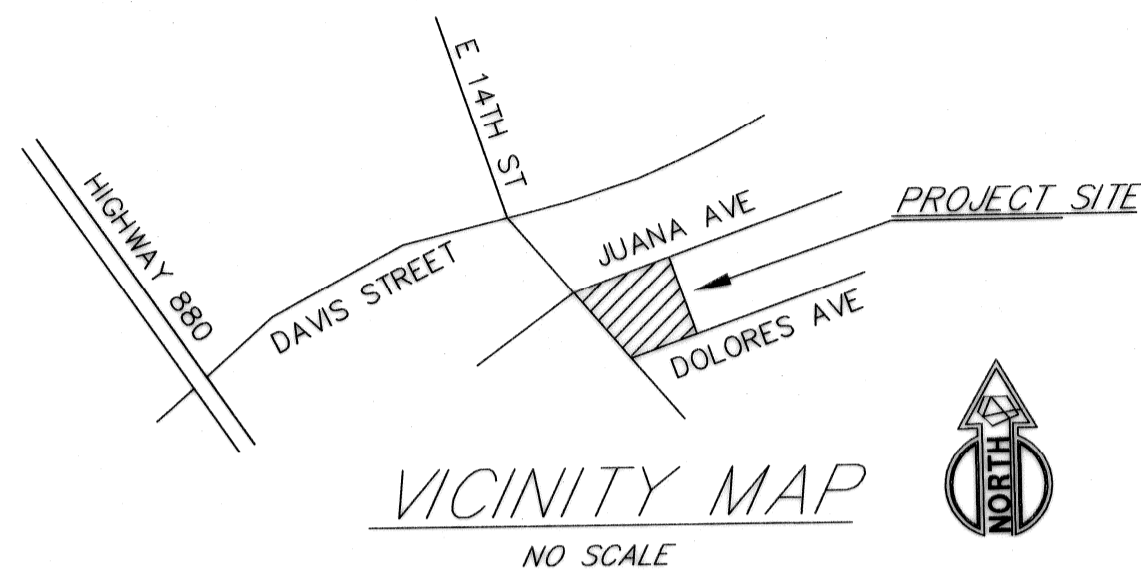

**BENEFICIARY'S STATEMENT**

THE UNDERSIGNED, AS BENEFICIARY UNDER THE DEED OF TRUST RECORDED March 12, 2014 # 2014066822, ALAMEDA COUNTY OFFICIAL RECORDS, DOES HEREBY JOIN IN AND CONSENT TO THE FOREGOING OWNER'S STATEMENT.

James G. Ochsner  
SIGNATURE  
JAMES G. OCHSNER, SRV. P.  
(PRINT NAME/TITLE)

**BENEFICIARY'S ACKNOWLEDGMENT**

STATE OF CALIFORNIA )  
COUNTY OF San Mateo ) SS

ON 6/12/14, 2014, BEFORE ME Alex Izard A NOTARY PUBLIC IN AND FOR SAID COUNTY, PERSONALLY APPEARED James G. Ochsner WHO PROVED TO ME ON THE BASIS OF SATISFACTORY EVIDENCE TO BE THE PERSON(S) WHOSE NAME IS SUBSCRIBED TO THE WITHIN INSTRUMENT AND ACKNOWLEDGED TO ME THAT THEY EXECUTED THE SAME IN THEIR AUTHORIZED CAPACITY, AND THAT BY THEIR SIGNATURE ON THE INSTRUMENT THE PERSON(S) OR ENTITY UPON BEHALF OF WHICH THE PERSON(S) ACTED, EXECUTED THE INSTRUMENT.

I CERTIFY UNDER PENALTY OF PERJURY UNDER THE LAWS OF THE STATE OF CALIFORNIA THAT THE FORGOING PARAGRAPH IS TRUE AND CORRECT.

WITNESS MY HAND  
SIGNATURE: [Signature] June 18, 2015  
NOTARY'S SIGNATURE EXPIRATION OF NOTARY'S COMMISSION  
Alex Izard  
PRINT NOTARY'S NAME COUNTY  
San Mateo  
COMMISSION # 1937650  
PRINCIPAL PLACE OF BUSINESS

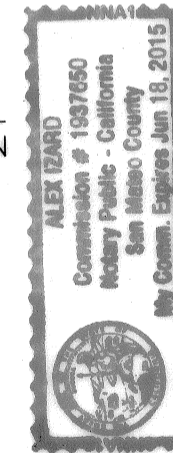

**CERTIFICATE OF CLERK OF BOARD OF SUPERVISOR**

I, CHERYL PERKINS, ASSISTANT CLERK OF THE BOARD OF SUPERVISORS FOR THE COUNTY OF ALAMEDA, STATE OF CALIFORNIA, DO HEREBY CERTIFY, AS CHECKED BELOW THAT:

AN APPROVED BOND HAS BEEN FILED WITH THE SUPERVISOR OF THE SAID COUNTY AND STATE IN THE AMOUNT OF \$ \_\_\_\_\_ CONDITIONED FOR PAYMENT OF ALL TAXES AND SPECIAL ASSESSMENTS COLLECTED AS TAXES WHICH ARE NOW A LIEN AGAINST SAID LAND OF ANY PART THEREOF BUT NOT YET PAYABLE AND WAS DULY APPROVED BY SAID BOARD IN SAID AMOUNT.

ALL TAXES AND SPECIAL ASSESSMENTS COLLECTED AS TAXES HAVE BEEN PAID AS CERTIFIED BY THE TREASURER TAX COLLECTOR OF THE COUNTY OF ALAMEDA

CHERYL PERKINS  
ASSISTANT CLERK OF THE BOARD  
OF SUPERVISORS FOR THE COUNTY OF ALAMEDA,  
STATE OF CALIFORNIA

DATE: \_\_\_\_\_

BY: \_\_\_\_\_  
DEPUTY CLERK

**CITY SURVEYOR'S STATEMENT**

I, Frank C. Bellecci, CITY SURVEYOR OF THE CITY OF SAN LEANDRO, COUNTY OF ALAMEDA, STATE OF CALIFORNIA DO HEREBY STATE THAT I HAVE EXAMINED THE HEREIN EMBODIED MAP ENTITLED "PARCEL MAP 10227" AND I AM SATISFIED THAT THE MAP IS TECHNICALLY CORRECT.

Frank C. Bellecci  
FRANK C BELLECCI LS 5399  
REGISTRATION EXPIRES 9/30/14  
CITY SURVEYOR FOR THE CITY OF SAN LEANDRO  
COUNTY OF ALAMEDA, STATE OF CALIFORNIA



6-19-14

**SURVEYOR'S STATEMENT**

THIS MAP WAS PREPARED BY ME OR UNDER MY DIRECTION AND IS BASED UPON A FIELD SURVEY IN CONFORMANCE WITH THE REQUIREMENTS OF THE SUBDIVISION MAP ACT AND LOCAL ORDINANCE AT THE REQUEST OF INNISFREE COMPANY ON JULY 5, 2011. I HEREBY STATE THAT THIS PARCEL MAP SUBSTANTIALLY CONFORMS TO THE CONDITIONALLY APPROVED TENTATIVE MAP, I FURTHER STATE THAT ALL THE MONUMENTS SHOWN HEREON WILL BE OF THE CHARACTER AND OCCUPY THE POSITIONS INDICATED THE MONUMENTS ARE SUFFICIENT TO ENABLE THE SURVEY TO BE RETRACED.

DATED THIS 9TH DAY OF JUNE, 2014

Dirk C. Slooten  
LS 5342



**CITY ENGINEER'S STATEMENT**

I, Kenneth C. Joseph, CITY ENGINEER FOR THE CITY OF SAN LEANDRO, COUNTY OF ALAMEDA, STATE OF CALIFORNIA DO HEREBY STATE THAT I HAVE EXAMINED THE HEREIN EMBODIED MAP ENTITLED "PARCEL MAP 10227, CITY OF SAN LEANDRO, ALAMEDA COUNTY, STATE OF CALIFORNIA" CONSISTING OF TWO (2) SHEETS, THIS STATEMENT BEING UPON SHEET 1 THEREOF, THAT THE SUBDIVISION AS SHOWN UPON SAID MAP IS SUBSTANTIALLY THE SAME AS SAID SUBDIVISION APPEARED ON THE TENTATIVE MAP AND ANY APPROVED ALTERATION THEREOF; THAT ALL PROVISIONS OF THE SUBDIVISION MAP ACT OF THE STATE OF CALIFORNIA, AND AMENDMENTS THERETO AND OF ANY LOCAL ORDINANCE APPLICABLE AT THE TIME OF APPROVAL OF THE TENTATIVE MAP HAVE BEEN COMPLIED WITH.

Kenneth C. Joseph  
CITY ENGINEER: KENNETH C. JOSEPH RCE 34870  
REGISTRATION EXPIRES 9/30/2015  
CITY ENGINEER FOR THE CITY OF SAN LEANDRO  
COUNTY OF ALAMEDA, STATE OF CALIFORNIA



**CITY CLERK STATEMENT**

I, MARIAN HANDA CITY CLERK OF THE COUNCIL OF THE CITY OF SAN LEANDRO, COUNTY OF ALAMEDA, STATE OF CALIFORNIA, DO HEREBY STATE THAT THE HEREIN EMBODIED PARCEL MAP ENTITLED "PARCEL MAP 10236", CONSISTING OF TWO (2) SHEETS, THIS STATEMENT BEING ON SHEET ONE (1) THEREOF, AT THE REGULAR MEETING HELD ON THE \_\_\_\_\_ DAY OF \_\_\_\_\_, 20\_\_\_\_ AND THAT SAID DULY PASSES AND ADOPTED AT SAID MEETING APPROVE SAID MAP AND ACCEPTS THE RIGHT OF WAY DEDICATION ALONG JUANA AVENUE AS SHOWN HEREON.

IN WITNESS WHEREOF, I HAVE HEREUNTO SET MY HAND THIS \_\_\_\_\_ DAY OF \_\_\_\_\_, 20\_\_\_\_.

MARIAN HANDA  
CITY CLERK AND CLERK OF THE CITY COUNCIL  
OF THE CITY OF SAN LEANDRO,  
ALAMEDA COUNTY,  
STATE OF CALIFORNIA